



ASPIRE

— TO MOVE —



Bathwick Hill, Bath, BA2

Video and physical viewings available. Self contained studio flat with own entrance located on Bathwick Hill, Bath. Available from end of October 2025. Suitable for a single student.

Bathwick Hill is located on the south east side of Bath and this apartment is just 0.4 miles away from the university and 1 mile away from the city centre. There is a bus stop just outside the front door a Tesco express at the bottom of the hill.

£950 PCM

Bathwick Hill, Bath, BA2

- Studio apartment
- Available October 2025.
- Holding deposit: £219
- Fully furnished
- Suitable for a single mature student
- Deposit: £1096
- Courtyard garden
- Video tour available
- Water bill included in rent

Video and physical viewings available. Self contained studio flat with own entrance located on Bathwick Hill, Bath. Available from End of October - ideally the 22nd. Suitable for a single student.

Bathwick Hill is located on the south east side of Bath and this apartment is just 0.4 miles away from the university and 1 mile away from the city centre. There is a bus stop just outside the front door a Tesco express at the bottom of the hill.

The property is a separate studio flat located in the grounds of the landlord's own property, accessed through a gated driveway. The main room is furnished with a sofa, desk, double bed, chest of drawers and wardrobe. The kitchen is separate and there is a washer/dryer, fridge, microwave, kettle, toaster and hob. The bathroom has a shower, toilet and sink. There is a private patio garden at the front of the flat that has a table with chairs.

It is available from the end of October and would best suit a mature single student. Please note the water is included in the rent.

Council tax band G if applicable

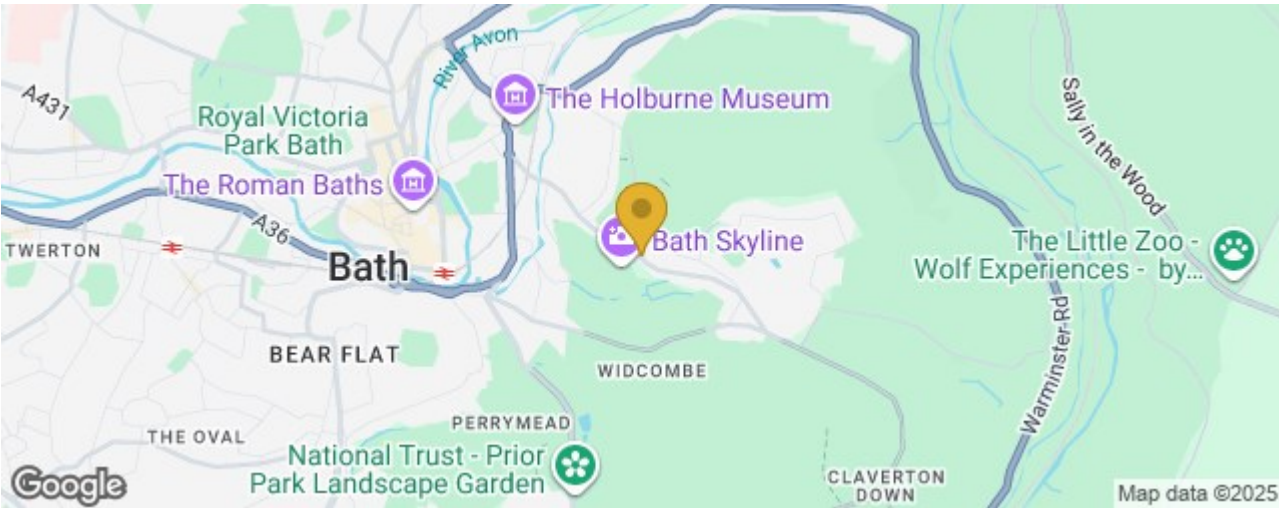



Floor Plan

FIRST FLOOR
345 sq.ft. (32.0 sq.m.) approx.

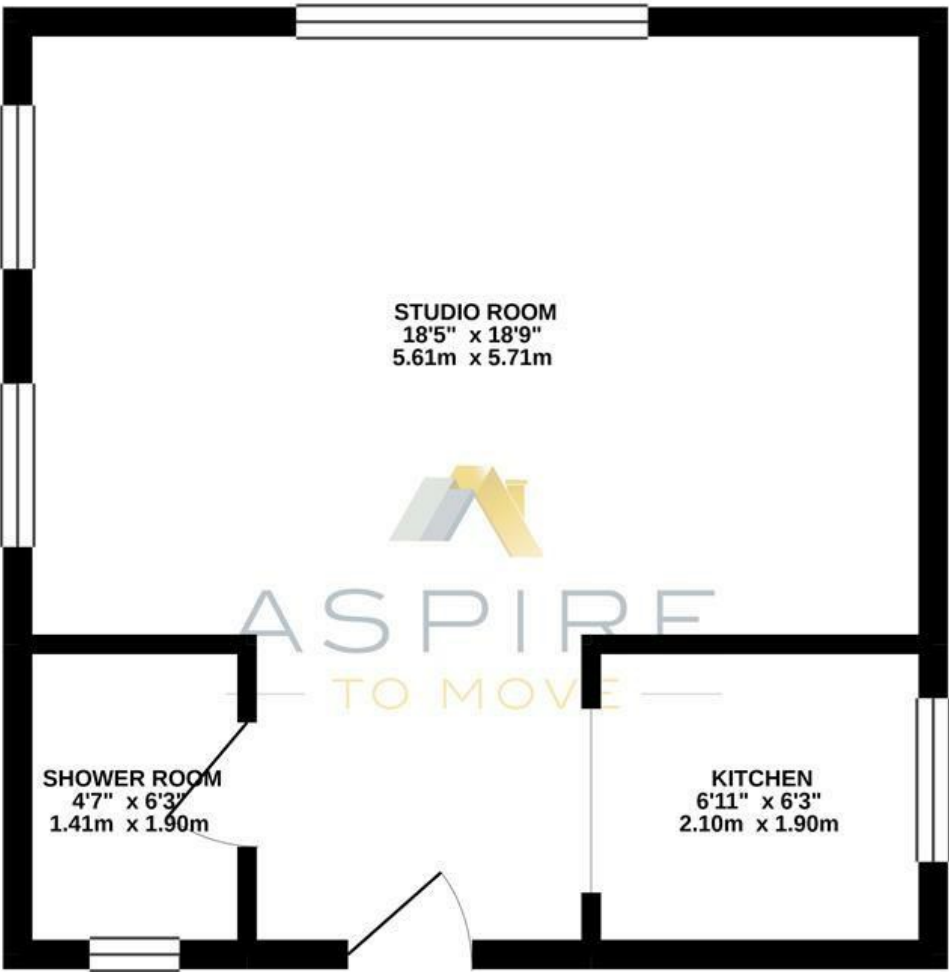

BATHWICK HILL, BATH, BA2

TOTAL FLOOR AREA : 345 sq.ft. (32.0 sq.m.) approx.

Whilst every attempt has been made to ensure the accuracy of the floorplan contained here, measurements of doors, windows, rooms and any other items are approximate and no responsibility is taken for any error, omission or mis-statement. This plan is for illustrative purposes only and should be used as such by any prospective purchaser. The services, systems and appliances shown have not been tested and no guarantee as to their operability or efficiency can be given.

Made with Metropix ©2021

These particulars, whilst believed to be accurate are set out as a general outline only for guidance and do not constitute any part of an offer or contract. Intending purchasers should not rely on them as statements of representation of fact, but must satisfy themselves by inspection or otherwise as to their accuracy. No person in this firms employment has the authority to make or give any representation or warranty in respect of the property.

